

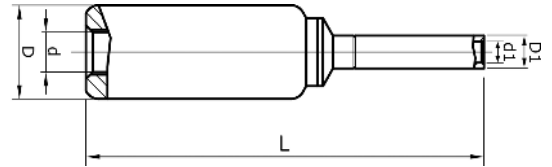

# ELPRESS®

## Product Datasheet



### Transition connectors of aluminium 16 - 95 mm<sup>2</sup> to solid copper 10 mm<sup>2</sup>

Stranded Al mm <sup>2</sup>	Solid Al mm <sup>2</sup>	mm <sup>2</sup> (Cu)	AWG Al (Stranded)	AWG Al (Solid Al)	AWG Cu	Name	d (mm)	d1	D	D1	L	s	s1	Pcs/pack	Tool
16	25	10	6	4	8	AKS16-10S	5,9	4,5	13	7	64,5	29	33	48	V600, V1300, V250
25	35	10	4	2	8	AKS25-10S	6,8	4,5	13	7	64,5	29	33	48	V600, V1300, V250
35	50	10	2	1/0	8	AKS35-10S	8,5	4,5	20	7	86	45	33	48	V1300, V250
50	70	10	1/0	2/0	8	AKS50-10S	9,6	4,5	20	7	86	45	33	24	V1300, V250
70	95	10	2/0	4/0	8	AKS70-10S	11,3	4,5	20	7	86	45	33	24	V1300, V250
95	120	10	4/0	250	8	AKS95-10S	12,5	4,5	25	7	101	60	33	24	V1300, V250

s = strip length (Al), s1 = strip length (Cu)



# ELPRESS®