



# ELPRESS®

## Product Datasheet

### Receptacles fully insulated rolled type

### 0.5 - 6 mm<sup>2</sup>

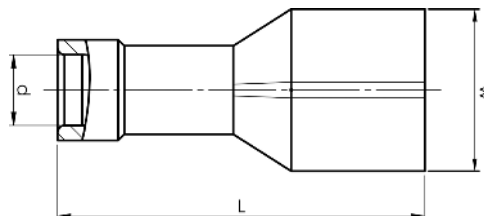

mm <sup>2</sup> (Cu)	AWG Cu	Name	W (mm)	d	L	s	For tab	Tool	Insulation material	Neck type	Easy Entry	Material	Pcs/ pack	Tool
0,5-1,5	20-16	A1503FLSF5	5,5	3,4	19,5	7	2,8x0,5	GSA0760	PA	Reinforcement sleeve	Yes	Brass, Cu/Sn	100	GSA0760
0,5-1,5	20-16	A1503FLSF8	5	3,4	19,5	7	2,8x0,8	GSA0760	PA	Reinforcement sleeve	Yes	Brass, Cu/Sn	100	GSA0760
0,5-1,5	20-16	A1505FLSF5	7,2	4,1	19,5	7	4,8x0,5	GSA0760	PA	Reinforcement sleeve	Yes	Brass, Cu/Sn	100	GSA0760
0,5-1,5	20-16	A1505FLSF8	7,2	4,1	19,5	7	4,8x0,8	GSA0760	PA	Reinforcement sleeve	Yes	Brass, Cu/Sn	100	GSA0760
0,5-1,5	20-16	A1507FLSF	8,8	4	21,3	7	6,3x0,8	GSA0760	PC	Brazed	Yes	Brass, Cu/Sn	100	GSA0760
1,5-2,5	16-14	A2505FLSF5	7,2	4,5	19,5	8	4,8x0,5	GSA0760	PA	Reinforcement sleeve	Yes	Brass, Cu/Sn	100	GSA0760
1,5-2,5	16-14	A2505FLSF8	7	3,9	19,5	8	4,8x0,8	GSA0760	PA	Reinforcement sleeve	Yes	Brass, Cu/Sn	100	GSA0760
1,5-2,5	16-14	A2507FLSF	8,8	4,5	21,3	8	6,3x0,8	GSA0760	PC	Brazed	Yes	Brass, Cu/Sn	100	GSA0760
4-6	12-10	A4607FLSF	9,2	5,4	26	9	6,3x0,8	GSA0760	PA	Reinforcement sleeve	Yes	Brass, Cu/Sn	100	GSA0760

s = strip length



# ELPRESS®